

FRAMELESS SPECIFICATIONS

KEY:
STANDARD
OPTIONAL

FLUSH OVERLAY

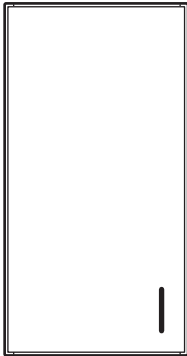

UPPER

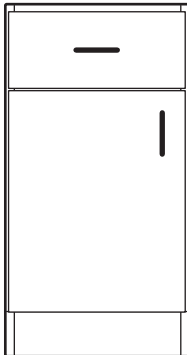

BASE

CASE CONSTRUCTION METHOD:

- DOWELS AND GLUE

CASE MATERIALS:

- 5/8" PARTICLE BOARD
- 5/8" MDF
- 5/8" PLYWOOD

SHELVES:

- 5/8" TWO SIDED WHITE, FULL DEPTH

SHELF SPACING & SUPPORT:

- 32mm SPACED DRILLED HOLES FOR SHELF HEIGHT ADJUSTMENT
- SEISMICALLY-RATED, LOCKING PLASTIC CLIP

INTERIOR FINISH:

- WHITE MELAMINE

FINISHED ENDS:

- INTEGRATED, MATCHING DOOR/DRAWER FACE

TOE:

- ADJUSTABLE LEG LEVELERS AND FINISHED 5/8" THICK x 4 1/2" HIGH TOE SKIN (APPLIED AFTER INSTALLATION)

WOOD FINISH (if applicable):

- ULTRA LOW VOC WATER-BASED SPRAY STAIN & WATER BASED HIGH PERFORMANCE UV CURED TOP COAT FINISH

HINGES:

- EUROPEAN-STYLE CONCEALED 6-WAY ADJUSTABLE, STANDARD CLOSE
- SOFT CLOSE UPGRADE

DRAWERS:

- SINGLE-WALL METAL DRAWER BOX SYSTEM WITH 5/8" WHITE MELAMINE BOTTOM AND BACK WITH INTEGRATED EPOXY COAT SIDE-MOUNT, THREE-QUARTER EXTENSION, STANDARD CLOSE GUIDES
- DOUBLE-WALL METAL DRAWER BOX SYSTEM WITH 5/8" WHITE MELAMINE BOTTOM AND BACK WITH INTEGRATED POWDER COAT, UNDER-MOUNT FULL-EXTENSION, SOFT CLOSE DRAWER GUIDES
- BUTT JOINT 1/2" PLYWOOD -or- 5/8" PARTICLEBOARD
- BUTT JOINT 5/8" WHITE WRAPPED PLYWOOD
- DOVETAIL 1/2" NATURAL BIRCH PLYWOOD

PLYWOOD DRAWER OPTIONS:

- FULL-EXTENSION, BALL BEARING, SIDE MOUNT, STANDARD CLOSE, 100LB RATING
- FULL-EXTENSION, UNDERMOUNT, CONCEALED, SOFT CLOSE

DOORS:

- MELAMINE – 4-SIDED EDGE BAND
- TEXTURED MELAMINE – 4-SIDED EDGE BAND
- RIGID THERMOFOIL (RTF) SLAB
- RIGID THERMOFOIL (RTF) RECESSED PANEL
- HIGH GLOSS OR SUPER MATTE PET SLAB
- HIGH GLOSS OR SUPER MATTE PET SHAKER
- WOOD VENEER – 4-SIDED EDGE BAND (Random grain match only)
- SOLID WOOD SLAB
- SOLID WOOD FRAME w/RECESSED VENEER PANELS
- SOLID WOOD FRAME w/RAISED SOLID WOOD PANELS
- HPL (HIGH-PRESSURE LAMINATE) SLAB
- 5-PIECE TEXTURED MELAMINE
- 5-PIECE PET SUPER MATTE

GRAIN DIRECTION:

DOOR: VERTICAL HORIZONTAL

DRAWER: VERTICAL HORIZONTAL

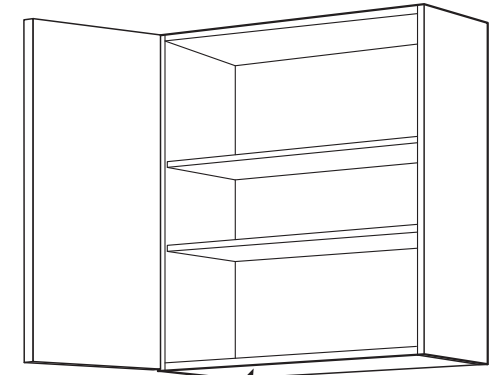

White melamine under upper cabinet

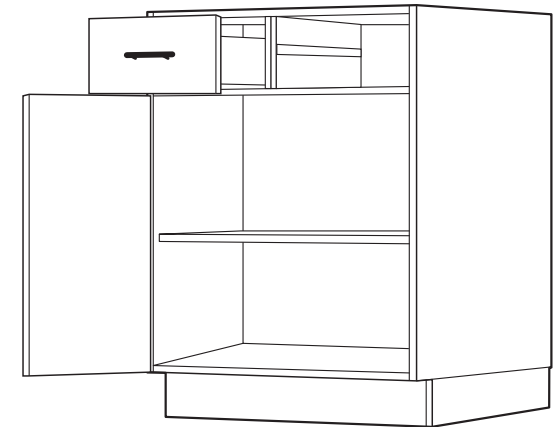

ADA ACCESSIBLE CABINETRY IS INCLUDED PER JURISDICTIONAL CODE

LANZ CAN PROVIDE SPECIALTY MATERIALS UPON REQUEST, ASK YOUR SALESPERSON.



LANZ SHEET GOODS MEET **TSCA TITLE VI** COMPLIANCE FOR FORMALDEHYDE CONTENT.

OPTIONS FOR NAF/ULEF ARE AVAILABLE

3025 WEST 7TH PLACE | EUGENE OREGON 97402 | 541.485.4050 | LANZCABINETS.COM

