

# FRAMELESS SPECIFICATIONS

KEY:  
STANDARD  
OPTIONAL

## FLUSH OVERLAY

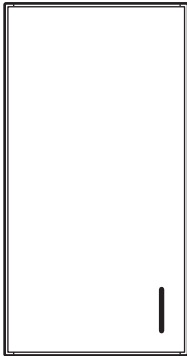

UPPER

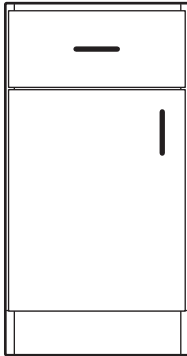

BASE

### CASE CONSTRUCTION METHOD:

- DOWELS AND GLUE

### CASE MATERIALS:

- 5/8" PARTICLE BOARD
- 5/8" MDF
- 5/8" PLYWOOD

### SHELVES:

- 5/8" TWO SIDED WHITE, FULL DEPTH

### SHELF SPACING & SUPPORT:

- 32mm SPACED DRILLED HOLES
- SEISMICALLY-RATED, LOCKING PLASTIC CLIP

### INTERIOR FINISH:

- WHITE MELAMINE

### FINISHED ENDS:

- INTEGRATED, MATCHING DOOR/DRAWER FACE

### TOE:

- ADJUSTABLE LEG LEVELERS AND FINISHED 5/8" THICK x 4 1/2" HIGH TOE SKIN (APPLIED AFTER INSTALLATION)

### WOOD FINISH (if applicable):

- ULTRA LOW VOC WATER-BASED SPRAY STAIN & WATER BASED HIGH PERFORMANCE UV CURED TOP COAT FINISH

### HINGES:

- EUROPEAN-STYLE CONCEALED 6-WAY ADJUSTABLE, STANDARD CLOSE
- SOFT CLOSE

### DRAWERS:

- SINGLE WALL METAL DRAWER BOX SYSTEM WITH 5/8" WHITE MELAMINE BOTTOM AND BACK WITH INTEGRATED EPOXY COAT SIDE-MOUNT, 3/4 EXTENSION, STANDARD CLOSE GUIDES
- DOUBLE WALL METAL DRAWER BOX SYSTEM WITH 5/8" WHITE MELAMINE BOTTOM AND BACK WITH INTEGRATED POWDER COAT, UNDER-MOUNT FULL EXTENSION, SOFT CLOSE GUIDES
- BUTT JOINT PLYWOOD
- DOVETAIL PLYWOOD
- BUTT JOINT WHITE WRAPPED PLYWOOD

### PLYWOOD DRAWER OPTIONS:

- 3/4-EXTENSION, WHITE EPOXY, STANDARD CLOSE
- FULL-EXTENSION, BALL BEARING, SIDE MOUNT, STANDARD CLOSE, 100LB RATING
- FULL-EXTENSION, UNDERMOUNT, CONCEALED, SOFT CLOSE

### DOORS:

- MELAMINE – 4-SIDED EDGE BAND
- TEXTURED MELAMINE – 4-SIDED EDGE BAND
- RIGID THERMOFOIL (RTF)
- HIGH GLOSS OR SUPER MATTE PET SURFACE
- VENEER – 4-SIDED EDGE BAND (Random grain match only)
- SOLID WOOD SLAB STYLE
- SOLID WOOD FRAME w/RECESSED VENEER PANELS
- SOLID WOOD FRAME w/RAISED SOLID WOOD PANELS
- HPL (HIGH-PRESSURE LAMINATE)
- 5-PIECE TEXTURED MELAMINE
- 5-PIECE PET SUPER MATTE

### GRAIN DIRECTION:

DOOR: VERTICAL HORIZONTAL

DRAWER: VERTICAL HORIZONTAL

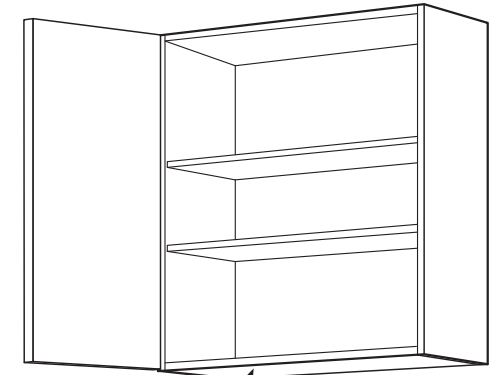

White melamine under upper cabinet

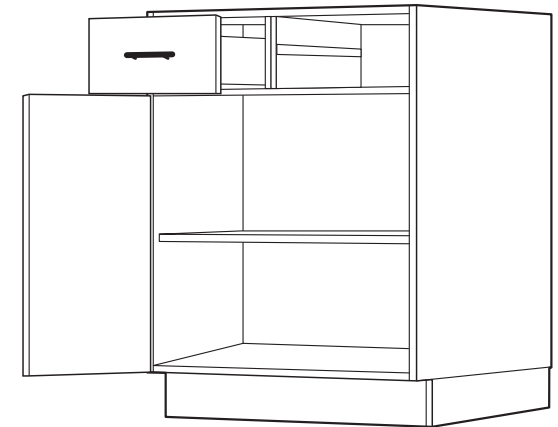

ADA ACCESSIBLE CABINETRY IS INCLUDED PER JURISDICTIONAL CODE

LANZ CAN PROVIDE SPECIALTY MATERIALS UPON REQUEST, ASK YOUR SALESPERSON.



LANZ SHEET GOODS MEET **TSCA TITLE VI** COMPLIANCE FOR FORMALDEHYDE CONTENT.

**OPTIONS FOR NAF/ULEF ARE AVAILABLE**

3025 WEST 7TH PLACE | EUGENE OREGON 97402 | 541.485.4050 | LANZCABINETS.COM

